

Dusk to Dawn Light

OB-DTD-80w | 150w



Key Features

- CERoHS SAA VEET IK10 DLC PSE certifications
- High CRI
- 130LM/W
- 5 Year standard warranty, 10 Year optional
- Rugged housing is powder-coat finished to last longer ,

Wind Resistance



Product Certification
Certified under CE, RoHS and PSE regulations

Housing
Durable, die-cast aluminum housing .

Light heatsink
Ultra slim heat sink design makes the lamp lighter.
Gray polyester powder coat finish
Twist-lock photocell included.

Mounting arm included

Twist-lock photocell included
Direct mounting hardware included



1. Adjustable to fit different sizes of arm
2. Mounting Bracket for the arm

CONSTRUCTION FEATURES

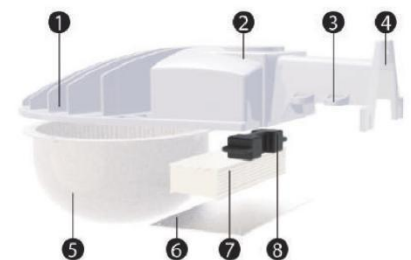

1. Die casting aluminum fixture body
2. Space reserved for 5/7 pin receptacle and photocell sensor
3. Connector which fits with arm in different sizes
4. Main bracket which supports different ways of installation
5. Optical grade polycarbonate cover
6. Access panel cover
7. Top level performance driver 1-10V dimmable
8. Surge protection device

- IP67
- SOSEN driver, input voltage AC85-277V
- Twist-lock photocell allows for dusk to dawn operation
- Replace MHL:400W
- Beam angle is 150°

DTD light

OB-DTD
80w | 150w

Product Page

Technical Specifications

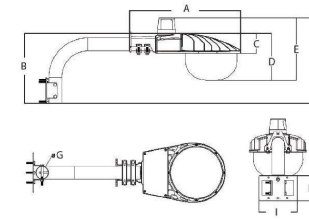

Power(±5%)	80W	150W
Lumen/W(±5%)	130Lm/W	130Lm/W
Lamp Flux(%)	10400Lm	19500Lm
LED Chips	SMD 3030	SMD 3030
Size:	512×90mm	512×90mm
Weight:	4KG	5.5KG
CCT	3000K/4000K/5000K/6000K	
CRI	80Ra	
Driver	Own Brand	SOSEN
Dimmable	0-10V(Optional)	0-10V(Optional)
Input Voltage	AC 100-277V/347V/480V	
DC Voltage	DC 36-48V	
Harmonic Distortion	≤15%	
Power Factor/Efficiency	>0.95/>92%	
Light Distribution	Symetrical	
Beam Angle	150°	
IP Grade/IK Grade	IK10	
Life-span	100,000Hours	
Working Temperature	"-20 ~ 55°F (-20~65℃)	
Storage Temperature	"-40 ~ 149°F (-20~55℃)	
Material	Diecast Alu.	
Installation	Suspension/Hanging rod	

WATTAGE	NET Weight	Gross Weight
80W	4KG	4.5 KG
150W	4.8 KG	5.9 KG

Rugged housing is powder-coat finished to last longer
Acrylic prismatic refractor with white polycarbonate reflector with stands the test of time.
LENS ASSEMBLY:
UV-Stabilized acrylic prismatic refractor
White polycarbonate reflector
Mounts directly or with mounting arm(included)
Mounts to pole diameter 2.4"

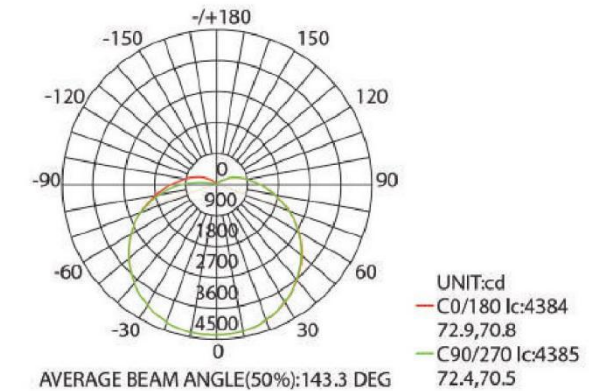

Green Features



- **Compact**
Robust enough to withstand the harshest environments and

packing punch with an outstanding
• **The brightness in different time schedule set by remote.**

- **Multi-directional Modules**
In Module Rotation 120°

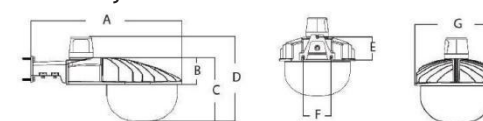

A	B
512mm/2.02'	90mm/0.35'
C	D
215mm/0.85'	286mm/1.13'
E	F
82mm/0.32'	102mm/0.40'
G	H
277mm/1.09'	

- **Applications**

• A sturdy Dusk to Dawn Lamp with photocell option is maintenance free solution to outdoor area lighting needs in residential or commercial applications. Widely used in garages, yard, dock, back yard, barns, farms, alleyways, roadway, parking lots, sidewalk, porch, building wall and commercial usage as over night security, area and perimeter lighting.

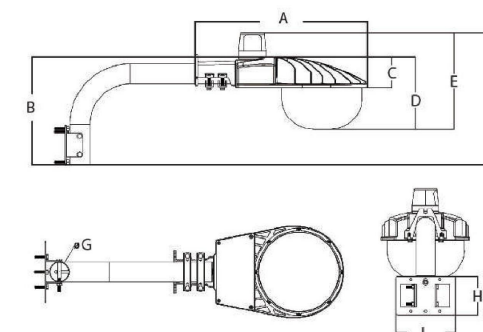

A	B
512mm/2.02'	320mm/1.26'
C	D
90mm/0.35'	215mm/0.85'
E	F
286mm/1.13'	392mm/1.54'
G	H
60mm/0.24'	120mm/0.47'
I	J
185mm/0.73'	

Outback
A+Prismtech Outback Lights Co.

Contact us NOW!

Tel: +86-755-8324 3047
Fax: +86-755-8324 3048

Skype: prismoutbacklight
Email: annie.chen@prismoutbacklight.com



Contact us NOW!

Tel: +86-755-8324 3047
Fax: +86-755-8324 3048

Skype: prismoutbacklight
Email: annie.chen@prismoutbacklight.com

